

# Firmware Installation Procedure

**Notice:** Do not turn off the power of the instrument or remove the USB memory during this operation.

## 1 Download the firmware

- 1) Download the Zip file to the computer.
- 2) Connect the USB memory to your computer.
- 3) Extract the \*.prg file and copy it to the root directory of your USB memory.

## 2 Connect the USB memory to the instrument

Connect the USB memory containing the downloaded files into the USB TO DEVICE terminal of the instrument.

**Notice:** Make sure that the USB memory is properly connected to the terminal.  
Excessive force or incorrect insertion may damage the terminal.

## 3 Install the firmware

- 1) Hold down STYLE CONTROL [START/STOP] button on the panel and turn the power on simultaneously.

[START/STOP] button

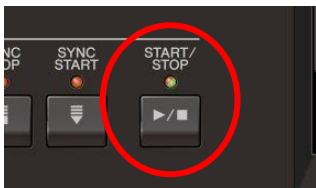

- 2) Keep holding down the [START/STOP] button until the following message appears:

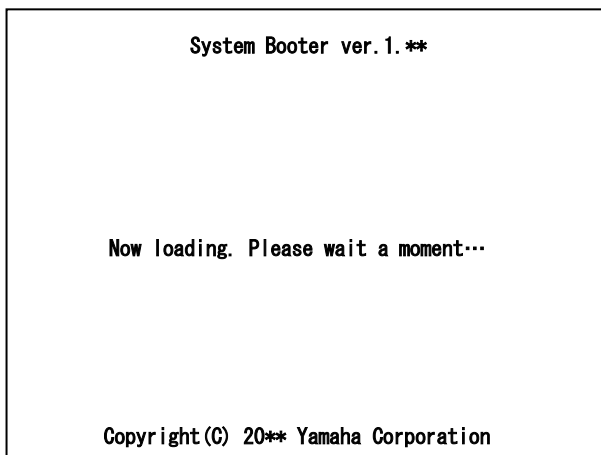

- 3) When the following message appears after a few moments, press the [START/STOP] button.

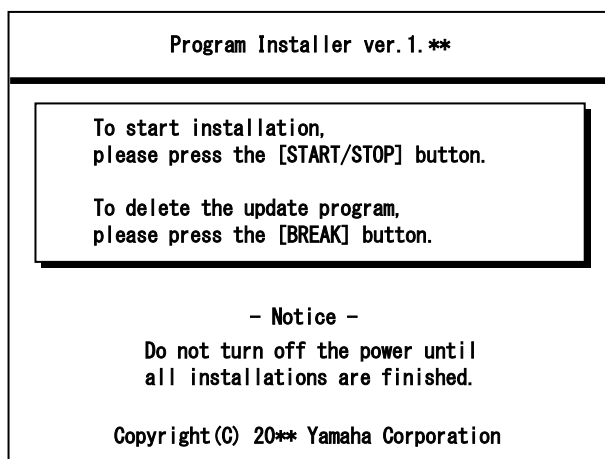

- 4) When the following message appears, press the [START/STOP] button to start firmware installation. A progress bar for installation will appear.

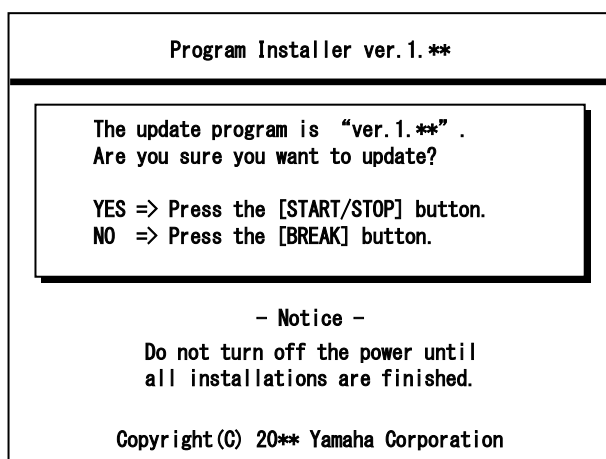

- 5) When firmware installation is complete, the following message appears with the new firmware version. Press the power button on the instrument to turn it off.

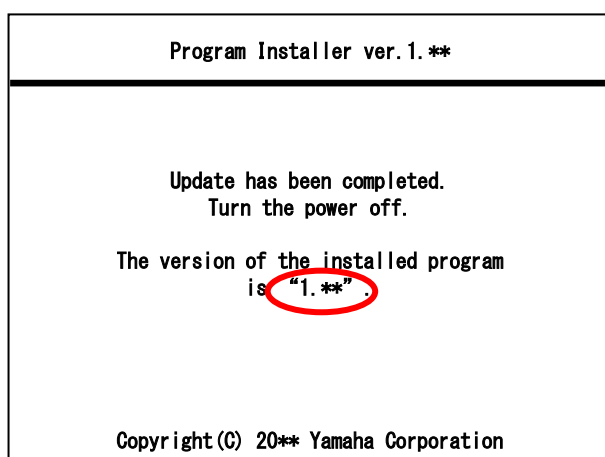

## Confirm the version number

### CVP-709/705

1. Turn the power on and wait until the home window is displayed. (1) Tap the menu icon to open the menu window. And (2) tap the right-arrow icon to move the second menu page. And (3) tap the utility icon.

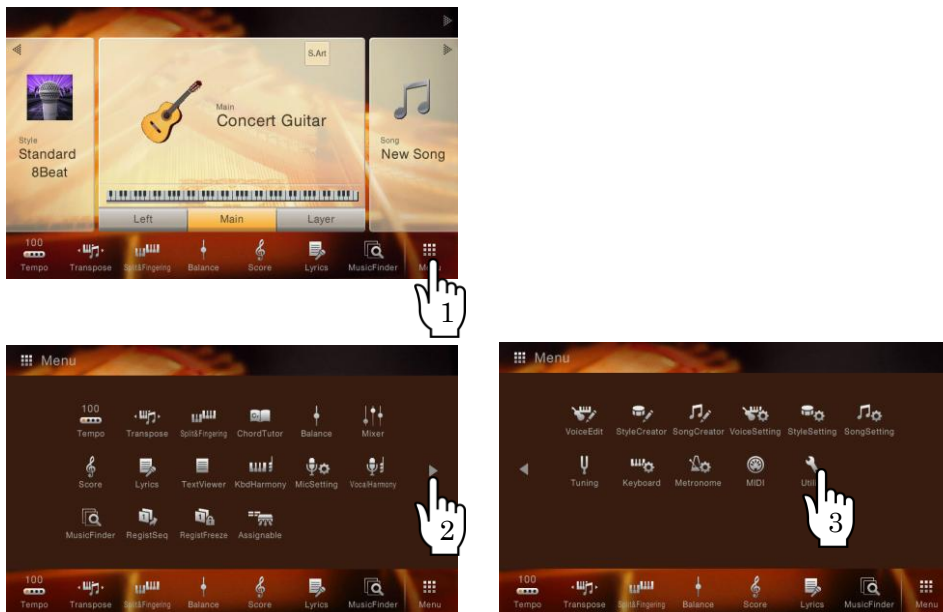

2. (4) Tap the system tab. You can find the version.

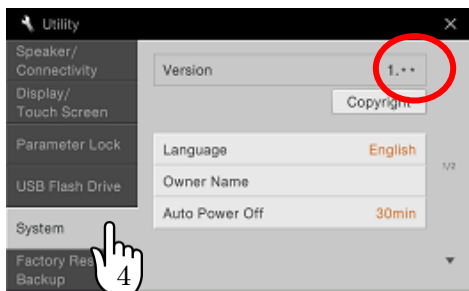

## Troubleshooting

- 1) **The power supply was cut off or the USB memory was removed during operation.**

A complete reinstall is necessary. Perform the operation again from the beginning.

- 2) **The installation cannot be executed and an error message appears in the display.**

Check the following:

- ✓ Is the USB memory inserted correctly?
- ✓ Is the USB connector free from dust or dirt?
- ✓ Is all required data located in the root directory of USB memory?
- ✓ Is the USB memory or the upgrade data itself damaged in some way?
- ✓ Does the data correspond to the instrument?

Try installing it again by using another USB memory.